

# Installation instructions for the *Ethos IS100* wood fire with a *Zero Clearance Cabinet* and *Econ-Air* flue system

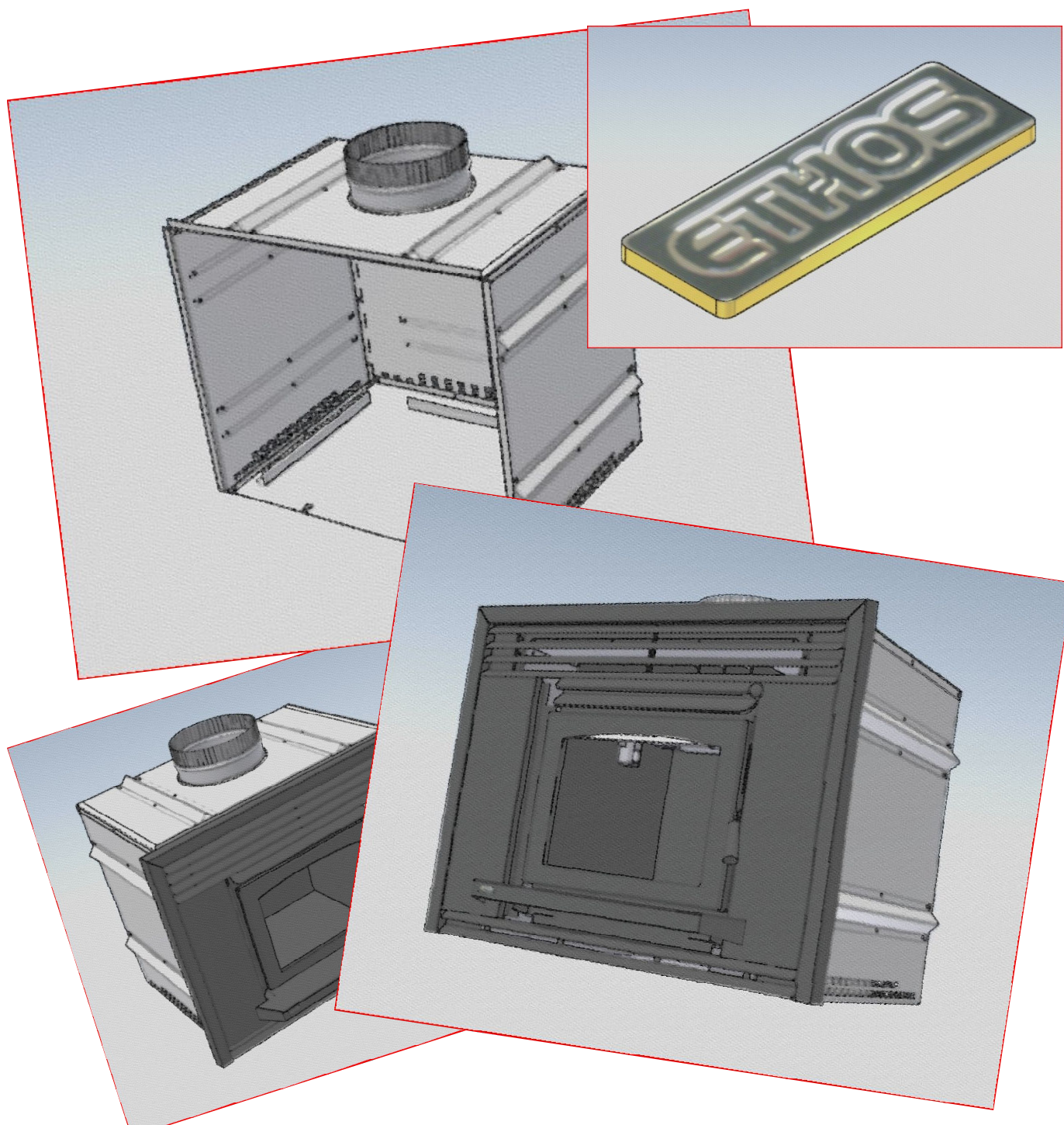

**Retain these instructions for future reference**

**These instructions should be read in conjunction with the instruction documents supplied with your *Ethos IS100* wood fire**

Following these instructions allows for the *Ethos IS100* wood fire to be safely installed in a timber frame wall, without the need for further heat protection past that supplied as part of the *Zero Clearance Cabinet* and the *Econ-Air flue system* (see notes regarding installation on combustible surfaces).

**WARNING: It is critical that these instructions are followed fully and that no substitute parts are used.**

#### Econ-Air flue system parts list:

3	130mm x 1200mm S/S flue	1	130mm x 600mm S/S flue
2	200mm x 1200mm galv. liner	1	200mm x 600mm galv. liner
1	200mm x 1200mm galv. liner with 'Z' brackets		
3	250mm x 1200mm galv. liner	1	250mm x 600mm galv. liner
4	40mm x 40mm x 600mm mounting rails	1	130mm spider bracket
1	Ethos IS cowl base (EXS-12002)	1	Ethos revolving cowl (EXS-12010)

## INSTALLATION NOTES

1. Combustible materials must be kept a minimum of 25mm away from all parts of the Zero Clearance Cabinet and the diameter 250 liner.
2. Adequate ventilation must be available for cooling the *Zero Clearance Cabinet* - see installation diagram for supplied ventilation plate mounting detail (page# 5).
3. Ethos insulation base panel (part# ZC1140) is required below the *Zero Clearance Cabinet* when in direct contact with combustible materials such as timber flooring.

**The *Econ-Air* flue system recovers the vented heat from the *Zero Clearance Cabinet* and recycles it back into the stove as combustion air for added efficiency.**

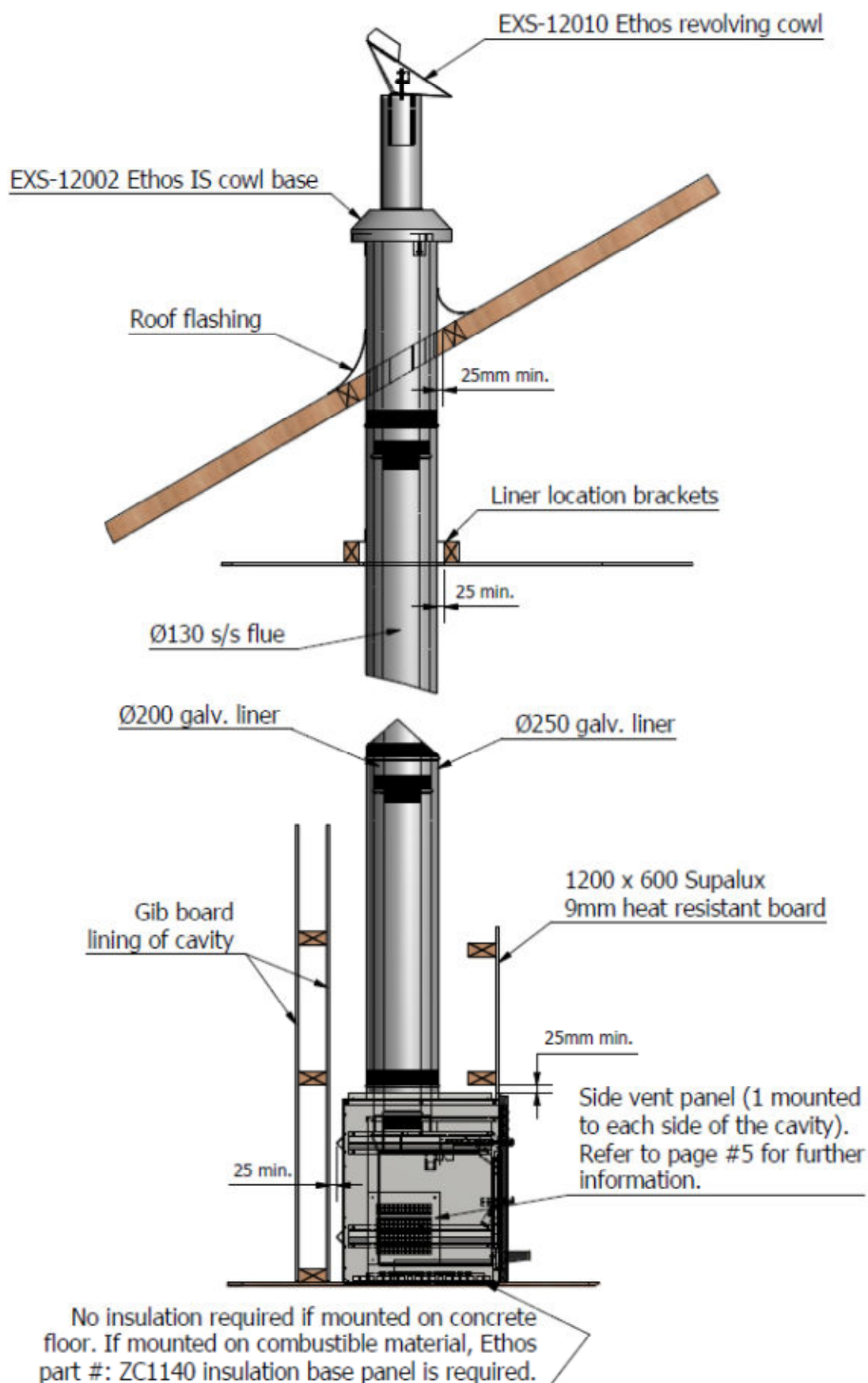



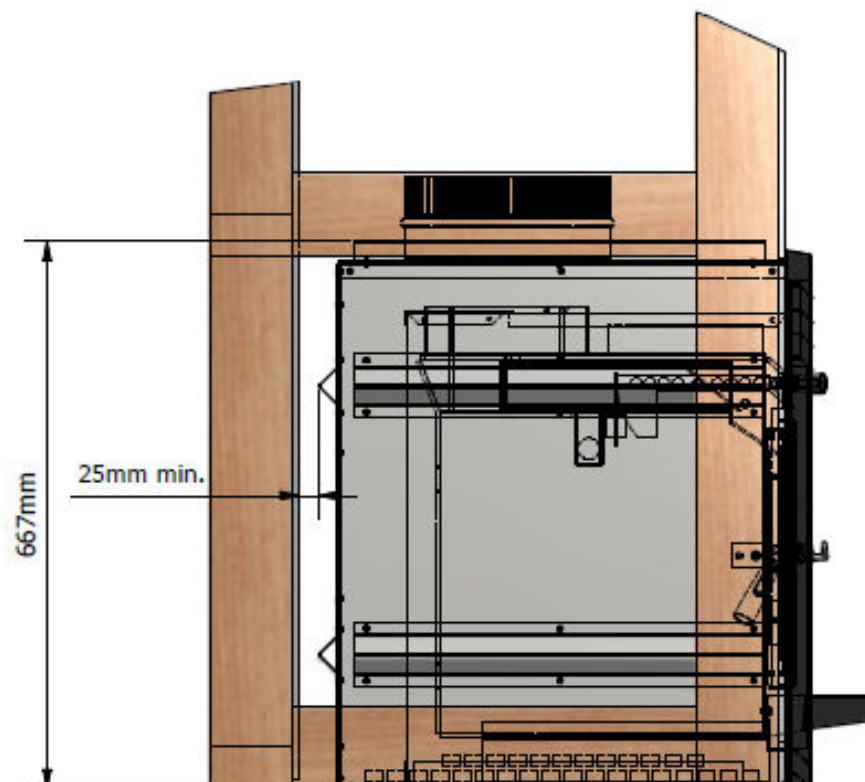
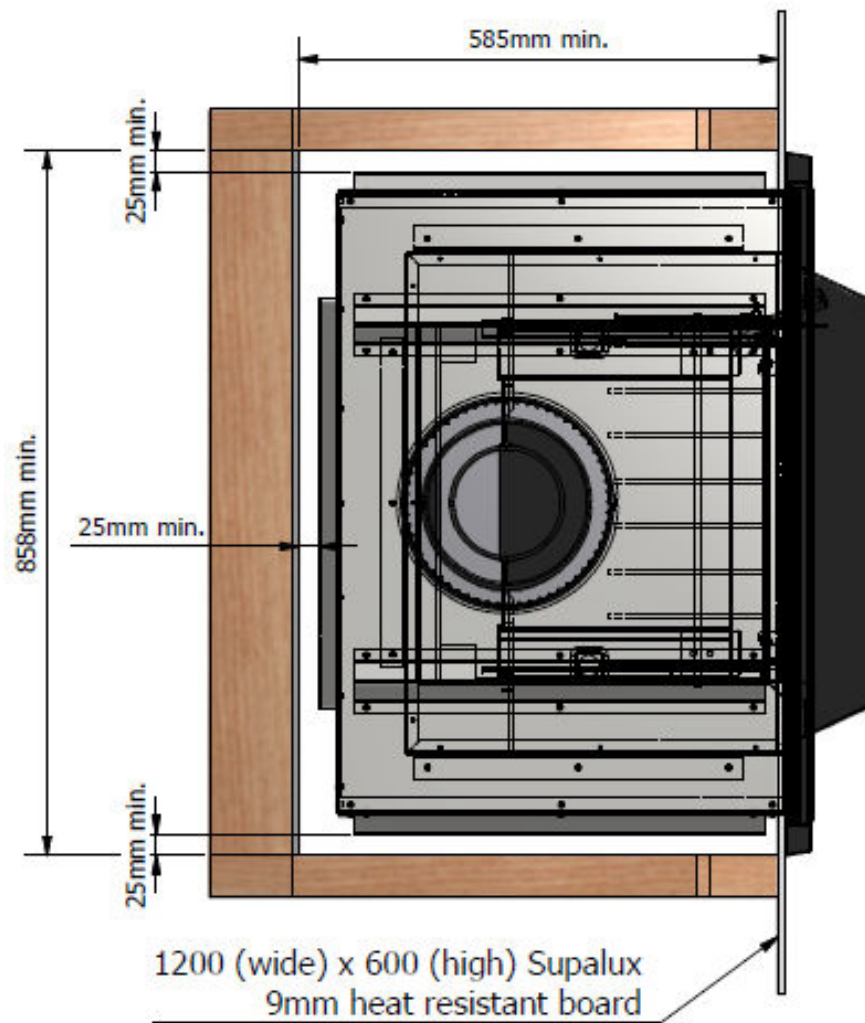

## Vent plates mounting detail

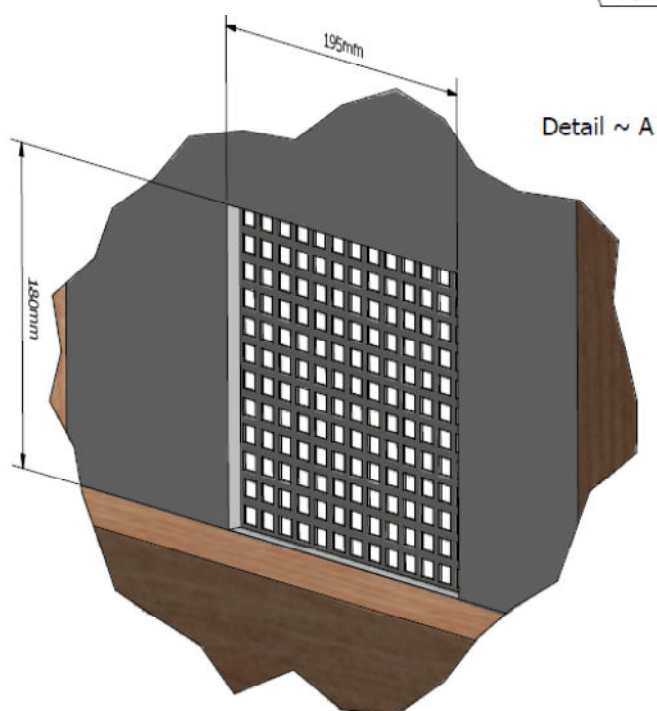
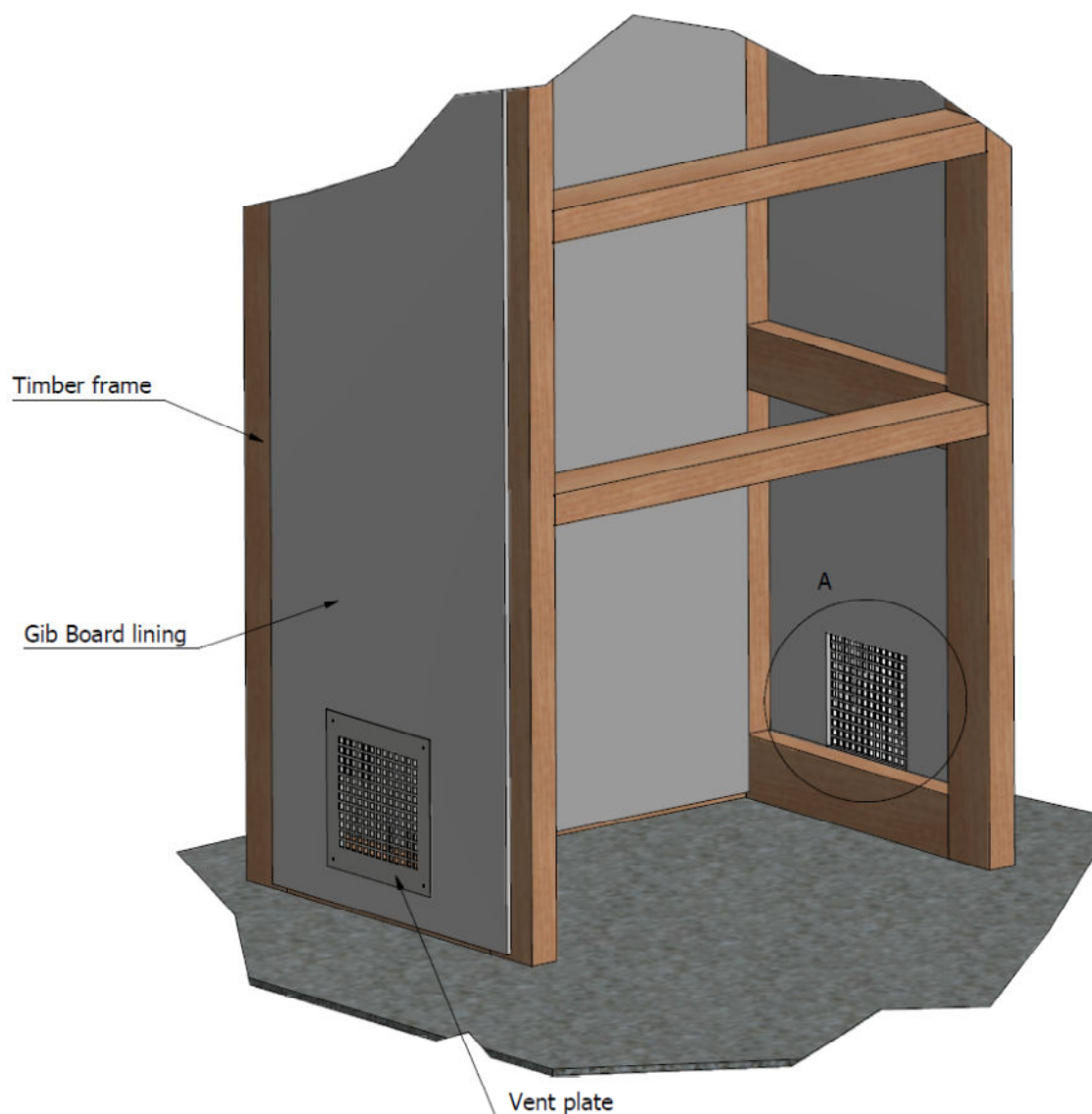

It is essential to provide adequate ventilation to the cavity. Mount supplied ventilation plates centrally and as low as the timber frame will allow. Ensure cavity has access to uninterrupted air supply.